



专注提高 专业服务

FOCUS ON IMPROVING PROFESSIONAL SERVICES

YIMAI SMART INTEGRATED WATER
PURIFICATION EQUIPMENT

艺迈智慧集成 净水设备



YIMAN 艺迈®

上海艺迈实业有限公司

Shanghai Yimai Industrial Co., Ltd

地址：上海市金山工业区金百路466号

Add: No.466, Jinbai Road, Jinshan Industrial Zone, Shanghai

服务热线/Tel: 400-821-3003

邮编/Post: 201506

网址/URL: <http://www.ym-sh.com>

企业邮箱/E-mail: ym@ym-sh.com

本公司保留对产品设计更改权利，个别参数如有变动，恕不另行通知。敬请谅解。
With the development of products, we reserve the right to alter the data, Please understand.



微信关注

版本号：202207020

企业简介

上海艺迈实业有限公司是一家集研发、生产、销售和服务为一体的高新技术企业。公司产品：水资源专用机械设备制造、智慧水务集成系列产品、成套供水集成系列产品、排污系列产品、餐厨（有机）垃圾处理系列产品、直饮水、集成水厂、电机和水泵等。生产基地坐落于上海金山工业经济开发区。

公司拥有精良的生产加工设备，并与同济大学环境科学与工程学院强强联合，建立“同济环境-艺迈联合实验室”，开展技术转让、成果转化、技术攻关等一系列技术研讨并深入合作。同期，学院还与我司合作建立“同济大学-上海艺迈实践教育基地”，并授予我司“同济大学‘卓越计划’校企联盟单位”称号。

艺迈主编三项餐厨废弃物就地处理设备团体标准且参编了多项国家标准、团体标准及技术手册。2020年荣获了“金山区小巨人”企业荣誉，获批成为“金山区企业技术中心”，成为金山区打响“上海制造”品牌的重要承载示范。2022年荣获国家级“专精特新”小巨人企业荣誉称号。

艺迈致力于为用户提供智慧水务系统解决方案，包含方案设计、设备制造以及专业的技术咨询与维护服务；公司在全国各省市均设有分支机构，并在业界赢得了良好的声誉。

艺迈秉承“专注提高，专业服务”的经营理念，贯彻务实工作作风和诚信负责的价值观念，为您提供高品质的产品和优质的解决方案，实现发展与共赢。



COMPANY PROFILE

Shanghai Yimai Industrial Co., Ltd. is a high-tech enterprise integrating R&D, production, sales and service. Main products of the company: manufacturing of special machinery and equipment for water resources, intelligent water affairs integration series products, complete water supply integration series products, sewage discharge series products, kitchen (organic) waste treatment series products, direct drinking water, integrated water plants, motors and pumps, etc. The production base is located in Shanghai Jinshan Industrial Economic Development Zone.

The company has excellent production and processing equipment, and has established a "Tongji Environment Yimai Joint Laboratory" in conjunction with the School of Environmental Science and Engineering of Tongji University to carry out a series of technical discussions and in-depth cooperation on technology transfer, achievement transformation, technology breakthrough, etc. At the same time, the college also cooperated with our company to establish "Tongji University - Shanghai Yimai Practical Education Base", and awarded our company the title of "Tongji University 'Excellence Program' University Enterprise Alliance Unit".

Yimai edited three group standards for on-site kitchen waste treatment equipment and participated in the compilation of a number of national standards, group standards and technical manuals. In 2020, it won the honor of "Small Giant in Jinshan District", was approved as the "Jinshan District Enterprise Technology Center", and became an important bearing demonstration for Jinshan District to launch the "Made in Shanghai" brand. In 2022, it won the honorary title of national "specialized, special and new" small giant enterprise.

Yimai is committed to providing users with intelligent water system solutions, including scheme design, equipment manufacturing and professional technical consulting and maintenance services; The company has branches in all provinces and cities across the country, and has won a good reputation in the industry.

Yimai adheres to the business philosophy of "focus on improvement and professional service", implements the pragmatic work style and the values of integrity and responsibility, and provides you with high-quality products and high-quality solutions to achieve development and win-win results.



CONTENTS

目录

艺迈智慧集成净水设备概述 Overview of Yimai Intelligent Integrated Water Purification Equipment	01
艺迈智慧集成净水设备处理工艺 Treatment process of Yimai intelligent integrated water purification equipment	02
艺迈智慧集成净水设备 Yimai intelligent integrated water purification equipment	04
艺迈智慧集成净水设备优势 Advantages of smart integrated water purification equipment of Yimai	05
艺迈智慧集成净水设备特点 Characteristics of smart integrated water purification equipment of Yimai	09
传统水厂VS艺迈智慧集成净水设备 Traditional Water Plant VS Yimai Smart Integrated Water Purification Equipment	10
智慧集成净水设备—远程监控平台 Intelligent integrated water purification equipment - remote monitoring platform	11
技术研发 Technology R & D	15
生产工艺 Production process	17
部分项目案例 Some project cases	19
艺迈服务 Yimai service	21

艺迈·发展历程

YIMAI · DEVELOPMENT HISTORY

艺迈通过多年的努力，公司已经逐步形成了自己的经营理念，形成了具有自身特色的企业精神，创造了企业品牌，在公众中树立了良好的形象。

Through years of operation, the company has gradually formed its own business philosophy, formed its own characteristic spirit of enterprise, created a corporate brand, and set up a good image in the public.

DEVELOPMENT

2011-2015 | 发展

- 自主研发全自动焊接设备
Self developed automatic welding equipment
- 荣获上海市高新技术企业
Won the title of Shanghai high tech enterprise
- 荣获五星级售后服务证书
Won the five-star after-sales service certificate
- 率先引入大型自动激光切割技术
Take the lead in introducing large-scale automatic laser cutting technology
- 参与编制《管网叠压供水设备》
《建筑排水新技术手册》标准
Participated in the preparation of standards for pipe network superimposed water supply equipment and new technical manual for building drainage

BREACH

2016-2018 | 突破

- 艺迈水泵荣获“能效之星”
Yimai pump won the "energy efficiency star"
- 主编《餐厨废弃物智能处理设备》
《餐厨废弃物智能处理设备应用技术规程》
《餐厨废弃物智能处理设备选用与安装（一）》三项标准
Chief editor of three standards: intelligent kitchen waste treatment equipment, technical specification for application of intelligent kitchen waste treatment equipment, and selection and installation of intelligent kitchen waste treatment equipment (I)
- 与同济大学环境科学与工程学院合作建立联合实验室
Cooperate with the school of environmental science and engineering of Tongji University to establish a joint laboratory

TRANSCEND

2018-2021 | 超越

- 荣获金山区院士专家工作站
Won the honor of Jinshan District academician and expert workstation
- 荣获金山区技术企业中心
Jinshan District Technology Enterprise Center
- 荣获金山区科技小巨人称号
Won the title of Jinshan Science and technology giant
- 荣获十二星级售后服务证书
Won the 12 star after-sales service certificate

FUTURE

2022 — 未来

- 上海艺迈发展至今，始终坚持“专注提高·专业服务”的经营理念，致力于为客户提供高品质的产品和更合理的解决方案；坚定“以人为本·技术立足·精益求精”的经营战略，坚守“创一线品牌·做一流企业”的发展愿景，致力于打造国内驰名商标，国际著名品牌。

Since its development, Shanghai Yimai has always adhered to the business philosophy of "focusing on improvement and professional service", and is committed to providing customers with high-quality products and more reasonable solutions; Firmly adhere to the business strategy of "people-oriented, technology based and excellence", adhere to the development vision of "creating a first-class brand and becoming a first-class enterprise", and commit to building a domestic well-known trademark and an international famous brand

创立于/SINCE | 2009

取“技艺精湛，超古迈今”中“艺迈”为名成立上海艺迈实业有限公司
Shanghai Yimai Industrial Co., Ltd. was established under the name of "Yimai" in "exquisite craftsmanship, surpassing the past and surpassing the present"

艺迈智慧集成净水设备概述

OVERVIEW OF YIMAI INTELLIGENT INTEGRATED WATER PURIFICATION EQUIPMENT

艺迈智慧集成净水设备采用艺迈自主设计开发的先进的供水净化工艺技术、集预氧化处理、絮凝、沉淀、过滤于一体，集成化、模块化设计，辅以消毒模块和艺迈箱式变频二次供水模块，整体材质为优质不锈钢，设备运行过程中，全程监控水质，各模块之间均实现智慧运行，保证饮水和供水双安全。具有安装便捷、布局紧凑、占地面积小、水质信息收集齐全、智慧反馈，自控程度高、运行稳定高效、水质安全可靠等优点。

The smart integrated water purification equipment of Yimai adopts the advanced water supply purification process technology independently designed and developed by Yimai, including pre oxidation treatment, flocculation, sedimentation Filter in one, integrated and modular design, supplemented by disinfection module and Yimai box type frequency conversion secondary water supply module, the overall material is high-quality stainless steel During the standby operation, the water quality is monitored throughout the whole process, and intelligent operation is achieved between modules to ensure the safety of drinking water and water supply. Convenient installation and tight layout It has the advantages of small area, complete water quality information collection, intelligent feedback, high degree of self-control, stable and efficient operation, safe and reliable water quality, etc.

处理工艺因地制宜，出水水质更安全

The treatment process is adapted to local conditions, and the effluent quality is safer

根据当地水源水质情况，制定合理处理工艺，保证出水水质达标

According to the water quality situation, customize the treatment process to ensure that the effluent quality is up to standard

艺迈智慧集成净水设备处理工艺

TREATMENT PROCESS OF YIMAI INTELLIGENT INTEGRATED WATER PURIFICATION EQUIPMENT

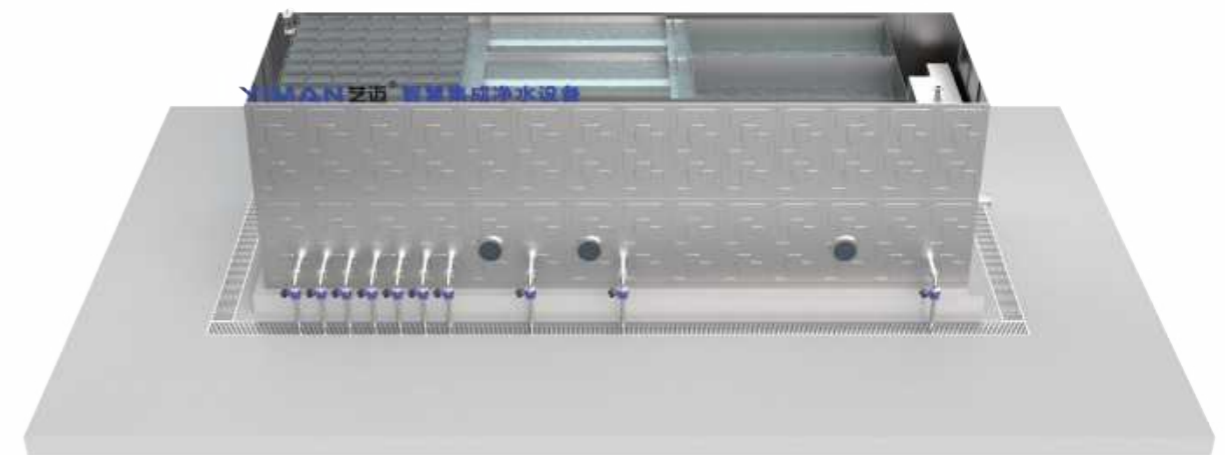

原水提升模块

Raw water lifting module

智慧集成泵站

Intelligent integrated pump station

预制提升泵站

Prefabricated lifting pump station

预处理模块

Preprocessing module

臭氧发生器

Ozone generator

次氯酸钠投加设备

Sodium hypochlorite dosing equipment

加药模块

Dosing module

PAC投加设备

PAC loading equipment

PAM投加设备

PAM feeding equipment

管道混合器

Pipeline mixer

净水模块

Water purification module

集成式一体化

Integrated integration

净水设备

Water purification equipment

反冲洗泵、鼓风机

Backwash pump, blower

消毒模块

Disinfection modules

次氯酸钠发生器

Sodium hypochlorite generator

智能输水模块

Intelligent water delivery module

智能箱式储水加压设备

Intelligent tank type water storage and pressure equipment

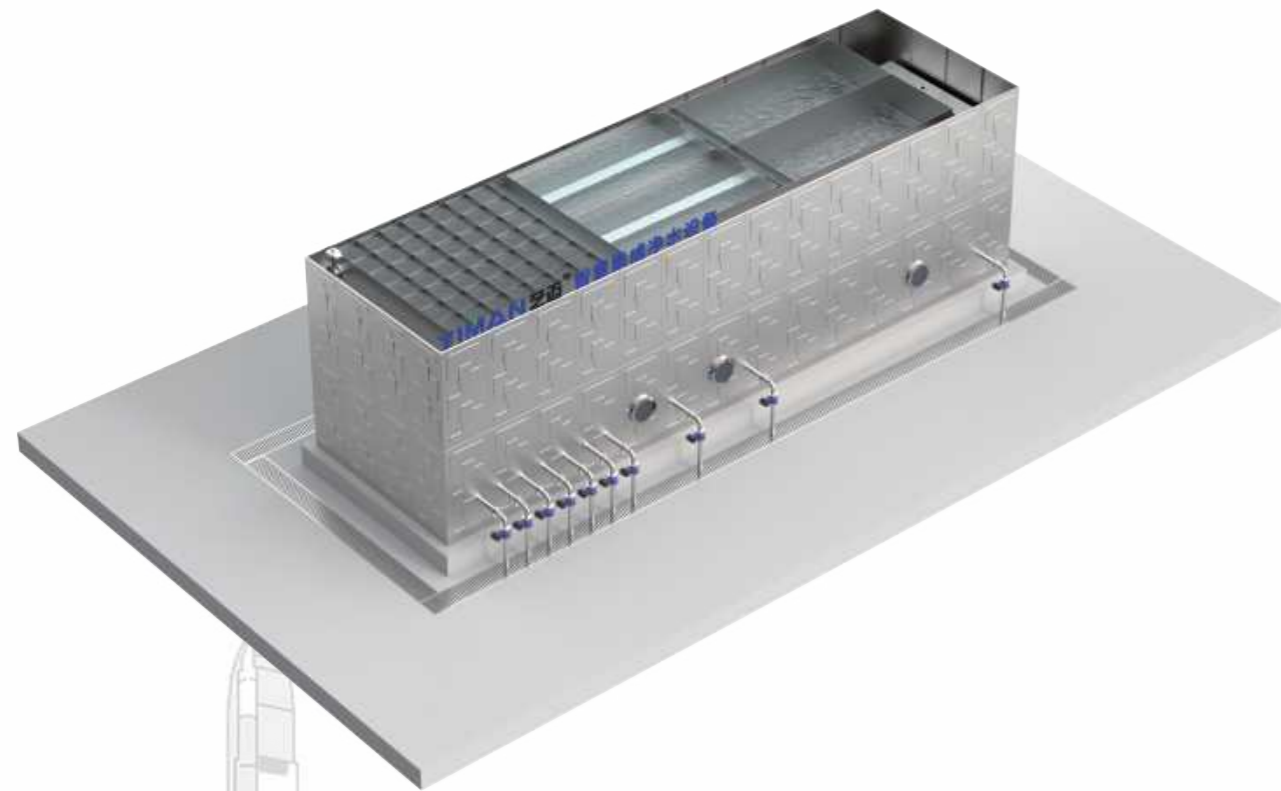
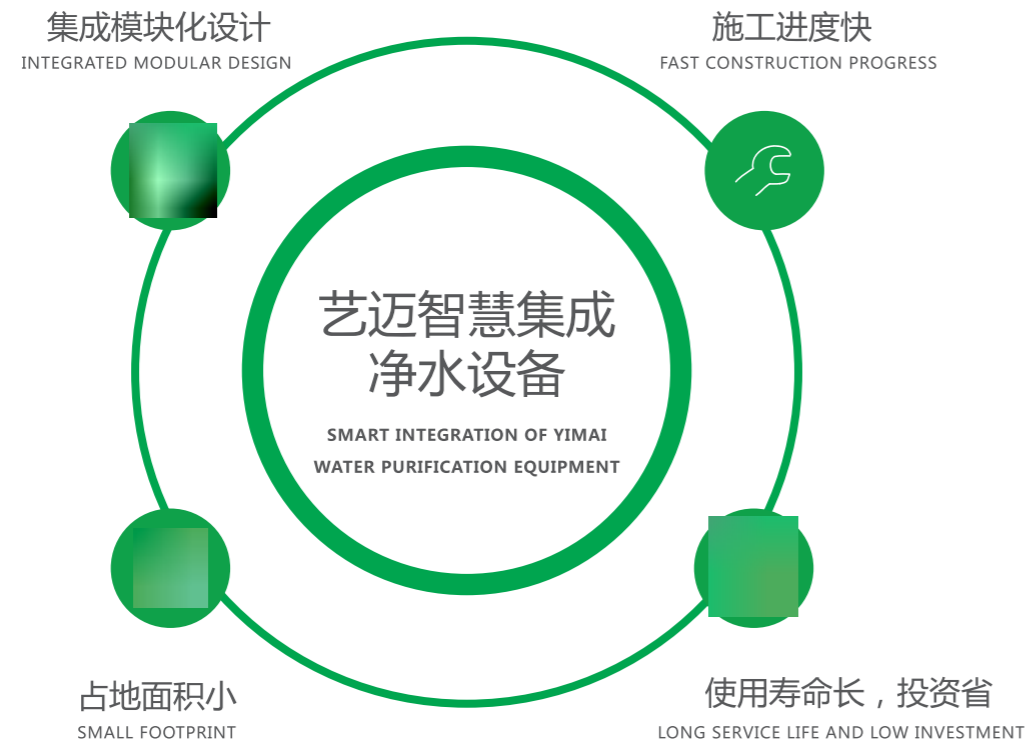

艺迈智慧集成净水设备

YIMAI INTELLIGENT INTEGRATED WATER PURIFICATION EQUIPMENT

- 安全供水
Safe water supply
- 集成模块化设计
Integrated modular design
- 施工进度快
Fast construction progress
- 占地面积小
Cover a small area
- 使用寿命长
Long service life
- 投资省
Investment province

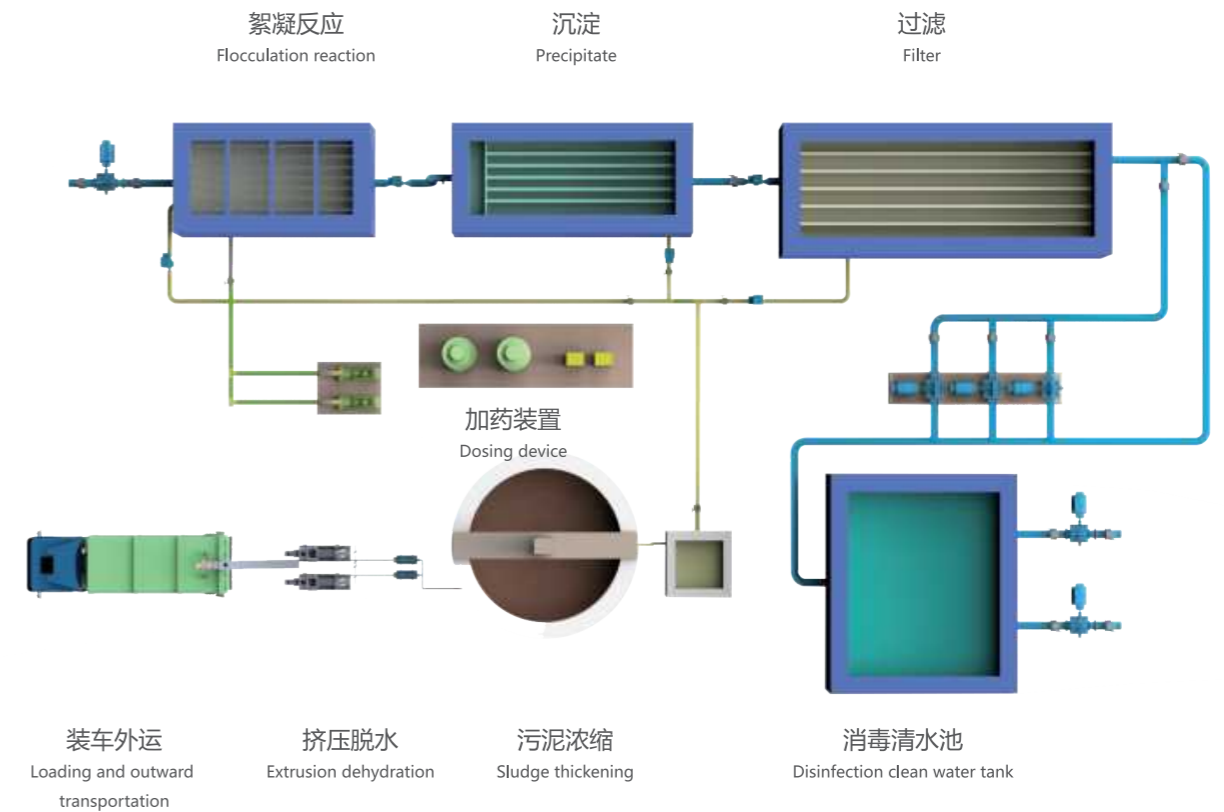

艺迈智慧集成净水设备优势

ADVANTAGES OF SMART INTEGRATED WATER PURIFICATION EQUIPMENT OF YIMAI

艺迈智慧集成净水设备——高效网格絮凝

Yimai intelligent integrated water purification equipment
- high efficiency grid flocculation

01

艺迈设计三段式网格絮凝池，采用独特的格栅网孔和过水孔，减少已成颗粒被打散的几率，增加颗粒物碰撞几率，提高颗粒物桥连效率。

Yimai designs a three-stage grid flocculation tank, which uses a unique grid Mesh and drain hole, reducing the probability of particles being dispersed, Increase particle collision probability and improve particle bridging efficiency.

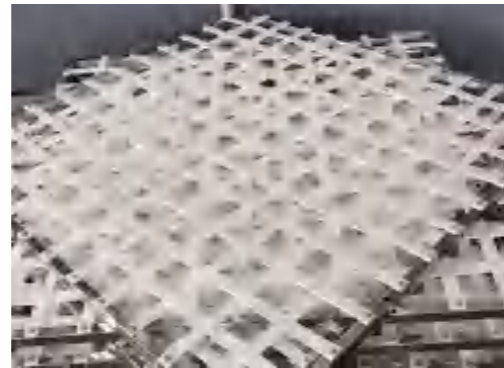

艺迈智慧集成净水设备——低阻高效混合装置

Yi Mai wisdom integrated water purification equipment --
low resistance high efficiency mixing device

02



每个混合单元相互交叉重叠,不仅实现了单元之间通过速率变向的混合,而且实现了内外层流体的相互混合,在减少阻力的同时,增加了混合效果,降低药耗和阻力,节能效果显著。

Each mixing unit overlaps with each other, which not only realizes the mixing of the units through the rate change direction, but also realizes the mutual mixing of the inner and outer layer fluids. In addition to reducing the resistance, the mixing effect is increased, the drug consumption and resistance are reduced, and the energy saving effect is significant.



03

艺迈智慧集成净水设备——斜管沉淀器

Yi Mai wisdom integrated water purification equipment - inclined tube precipitator

沉淀器是通过在沉淀分离区内设置若干数量薄板，单位占地面积上获得成倍有效沉淀面积的高效固液分离装置。

- 1、高效、占地少：与常规幅流式及竖流式沉淀器比较，可节省80%的占地面积。
- 2、良好的水力条件：无水力死角及漩涡，沉淀效果更佳。
- 3、斜板不堵塞：斜板倾角60度，板间距80~100mm，设有反洗装置。
- 4、排泥顺畅：艺迈设计的沉淀池均无死角，排泥建议用泵抽吸的排泥方式。

Precipitator is an efficient solid-liquid separation device which can obtain multiple effective precipitation area per unit area by setting a number of thin plates in the precipitation separation area

1. High efficiency, less occupation: compared with conventional amplitude flow and vertical flow precipitator, it can save 80% occupation area.
2. Good hydraulic conditions: no hydraulic dead Angle and whirlpool, better precipitation effect.
3. The inclined plate is not blocked: the inclined plate Angle is 60 degrees, the plate spacing is 80~100mm, and the backwashing device is provided.
4. Smooth mud discharge: The sediment tank designed by Yimai has no dead Angle, and it is recommended to use pump suction for mud discharge.

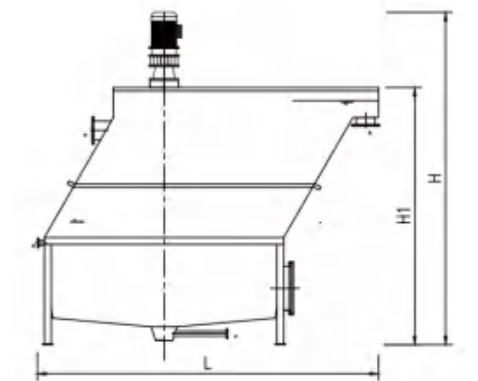

04

艺迈集成净水设备——加药装置

Yimai integrated water purification equipment - dosing device

自动加药设备是以计量泵为主要投加设备，由溶药箱、搅拌器、液位计、安全阀、止回阀、压力表、过滤器、缓冲器、管路、阀门、底座、扶梯、自动监视系统、电力控制系统等按工艺流程组装而成。

根据水厂水量设计对应的投加流量，容器采用PE板设计，防腐蚀性强，全开口式药剂添加口，操作更简便。

The automatic dosing equipment takes the metering pump as the main dosing equipment Agitator, level gauge, safety valve, check valve, pressure gauge, filter Buffer, pipeline, valve, base, escalator, automatic monitoring system The power control system is assembled according to the process flow.

According to the water quantity of the water plant, the corresponding dosing flow is designed, and the container is set with PE plate Meter, strong corrosion resistance, full opening type reagent adding port, more convenient operation.

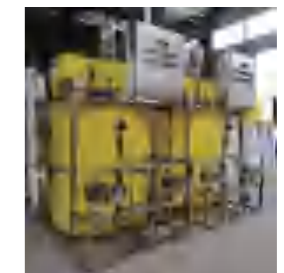

艺迈智慧集成净水设备优势

ADVANTAGES OF SMART INTEGRATED WATER PURIFICATION EQUIPMENT OF YIMAI

05

艺迈智慧集成净水设备——柱状膜过滤

Yi Mai wisdom integrated water purification equipment - Columnar membrane filtration

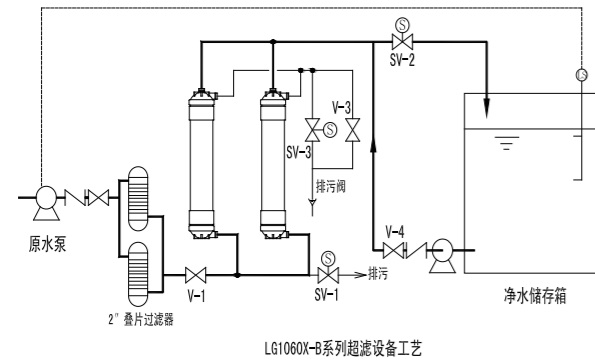

膜材料是耐污染、亲水的改性材料
Membrane materials are pollution resistant and hydrophilic modified materials

膜孔径分布均匀，过滤精度高
The pore diameter of the membrane is evenly distributed and the filtration accuracy is high

通量大且持久稳定，抗污染能力强 | 低压运行，能耗低
Membrane flux is large, durable and stable, anti-pollution ability is strong | Low pressure operation, low energy consumption

可以短时承受 200ppm 余氯环境，适用的 pH 范围为 2-13
Can withstand 200ppm of residual chlorine environment for a short time, the applicable pH range is 2-13

完全除菌，产水浊度小于 0.1NTU
Completely sterilized, turbidity less than 0.1NTU

交叉流设计，排除脏堵，提高寿命
Cross flow design, eliminate dirty blocking, improve service life

产品水的 SDI15 < 1 (原水浊度小于 20NTU 时的测试值)
SDI15 of product water < 1 (test value when raw water turbidity is less than 20NTU)

06

艺迈智慧集成净水设备——不锈钢箱体生产

Yi Mai wisdom integrated water purification equipment - stainless steel box production

设备整体采用优质不锈钢结构，美观大方，无腐蚀，无二次污染，使用寿命长。

The overall equipment is of high quality stainless steel structure, which is beautiful, free of corrosion, secondary pollution and long service life.

整体设备在车间标准化生产，缩短施工工期和调试工期。

The whole equipment in the workshop standardized production, shorten the construction period and debugging period.

经调试合格出厂后，现场通水通电即可投产，不把问题带到现场。

After passing the commissioning and leaving the factory, the project can be put into production with water and electricity on site, without bringing the problem to the site.

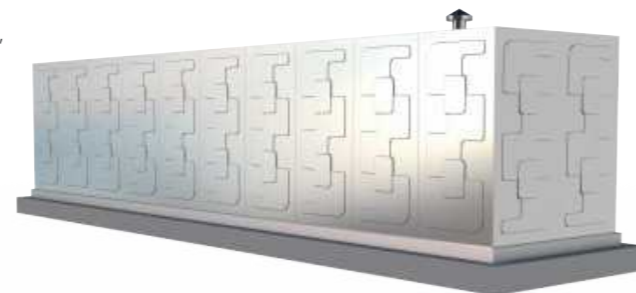

07

艺迈智慧集成净水设备——总规模智能切换

Yi Mai wisdom integrated water purification equipment - Total scale intelligent switching

艺迈智慧集成净水设备根据近期、远期设计规模和用水情况，把总规模分割成若干个独立制水单元，实现独立运行且相互备用，有效解决设计规模近期和运行规模不匹配、和远期规模不满足的供需矛盾。

Yimai smart integrated water purification equipment is based on the short-term and long-term Design scale and water use, dividing the total scale into Several independent water making units realize independent operation and Mutual backup, effectively solving the short-term and operation problems of design scale Supply of unmatched bank size and long-term scale Need contradiction.

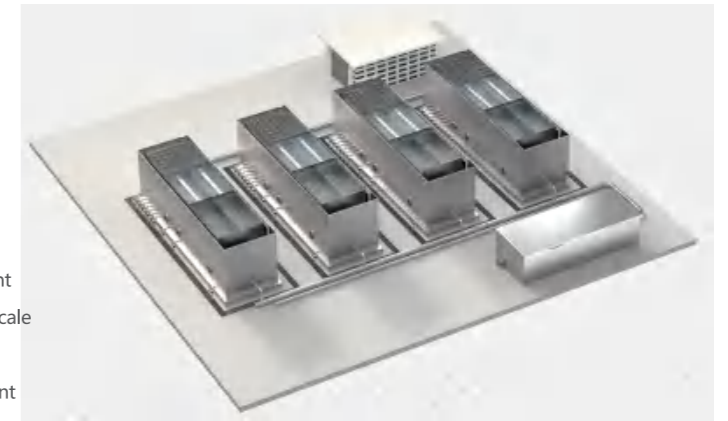

08

艺迈智慧集成净水设备——供水设备

Yi Mai wisdom integrated water purification equipment - Water supply equipment

艺迈供水设备，具备高度模块化、集成化、智能化的产品设计理念，能够实时监控储水水箱的进水量、液位、报警信息，并对二次加压供水设备的运行数据，异常报警，供水泵房的安防监控、视频门禁等系统进行远程监控。结合艺迈自主研发的智慧软件平台，与智慧集成净水设备整体联动，安全稳定的将净化水输送到千家万户。

Yimai water supply equipment, with a highly modular, integrated and intelligent product design concept, can monitor the water inflow, liquid level and alarm information of the water storage tank in real time, and remotely monitor the operation data of the secondary pressurized water supply equipment, abnormal alarm, security monitoring of the water supply pump room, video access control and other systems. Combined with the smart software platform independently developed by Yimai, it is integrated with smart integrated water purification equipment to safely and stably deliver purified water to thousands of households.



艺迈智慧集成净水设备特点

CHARACTERISTICS OF SMART INTEGRATED WATER PURIFICATION EQUIPMENT OF YIMAI

工艺成熟，按需定制

Mature process, customized as required

钢构预制造，模块化设计，现场拼装，工期短

Steel structure pre manufacturing, modular design, on-site assembly, short construction period

结构紧凑，占地少，投资省

Compact structure, less land and less investment

自适应智能化运行，全程线上可视化，实现无人值守智慧水厂

Adaptive intelligent operation, online visualization of the whole process, and realization of unattended smart water plant



传统水厂 VS 艺迈智慧集成净水设备

TRADITIONAL WATER PLANT VS YIMAI INTELLIGENT INTEGRATED WATER PURIFICATION EQUIPMENT

类型	传统土建工艺	艺迈智慧集成净水设备
工艺设计	繁琐周期长	集成化，可靠高效
使用材质	钢筋混凝土	优质不锈钢
技术先进性	传统技术	艺迈研发新技术
占地面积	占地面积大	约为土建水厂40%
建设周期	施工时间长	约为土建水厂20%
投资费用	建设费用高	约为土建水厂65%
施工精度	误差大	机械化制造，模块化组装，不锈钢板外包，内外美观
现代化水平	/	符合国家智慧水厂建设要求
运维管理	复杂	全自动
人员配置	约10人	3-4人
运维成本	成本高	仅为传统水厂65%
残余回收价值	建筑垃圾	回收价值高
建设周期内企业经济效益与社会效益	不明显	投产快，资金回报率高

智慧集成净水设备—远程监控平台

INTELLIGENT INTEGRATED WATER PURIFICATION EQUIPMENT - REMOTE MONITORING PLATFORM



安全防护体系

SAFETY PROTECTION SYSTEM



数据采集及传输体系

DATA ACQUISITION AND TRANSMISSION SYSTEM



智慧运行控制体系

Intelligent operation control system



管理维护体系

MANAGEMENT AND MAINTENANCE SYSTEM

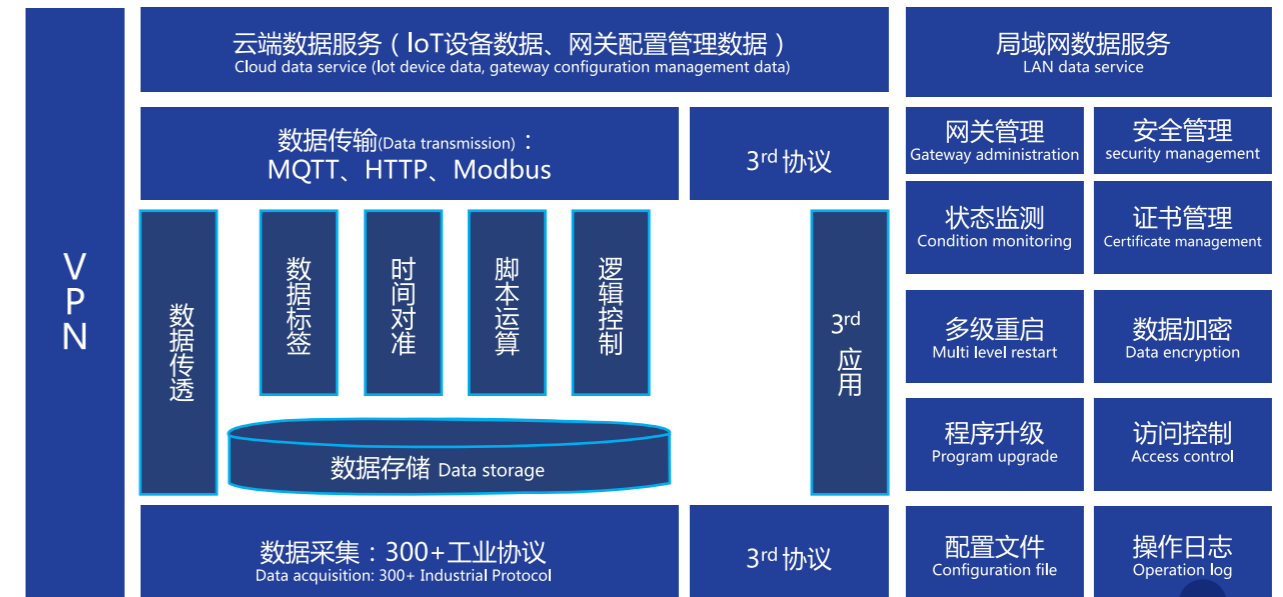

艺迈智慧集成净水设备，在基于对净水各模块设备设施的优化配置和建设基础上，融合了1000多个环保建设经验，结合现今物联网技术。（13个系统，围绕着1个中心目标--AI智慧集成水厂打造，提炼出4个建设体系）艺迈智慧集成净水将用户感知、智能识别、人机互动等先进技术进行有效集成，AI供水、智能运维，提升了集成水厂设备的使用寿命，规避了水污染风险，实现了设备的智慧运行、节能环保，保障了居民用水的便利与安全。

Yimai smart integrated water purification equipment based on the optimized configuration and construction of water purification equipment and facilities in each module, integrates more than 1000 environmental protection construction experiences, and combines the current Internet of Things technology. (13 systems, focusing on one central goal -- building AI smart integrated water plant, refined four construction systems) Yimai smart integrated water purification effectively integrates advanced technologies such as user perception, intelligent identification, human-computer interaction, and AI water supply, intelligent operation and maintenance, improving The service life of the integrated water plant equipment has been avoided, the risk of water pollution has been avoided, the intelligent operation of the equipment, energy conservation and environmental protection have been realized, and the convenience and safety of residential water use have been guaranteed.

智慧集成净水设备—手机APP

SMART INTEGRATED WATER PLANT—Mobile APP

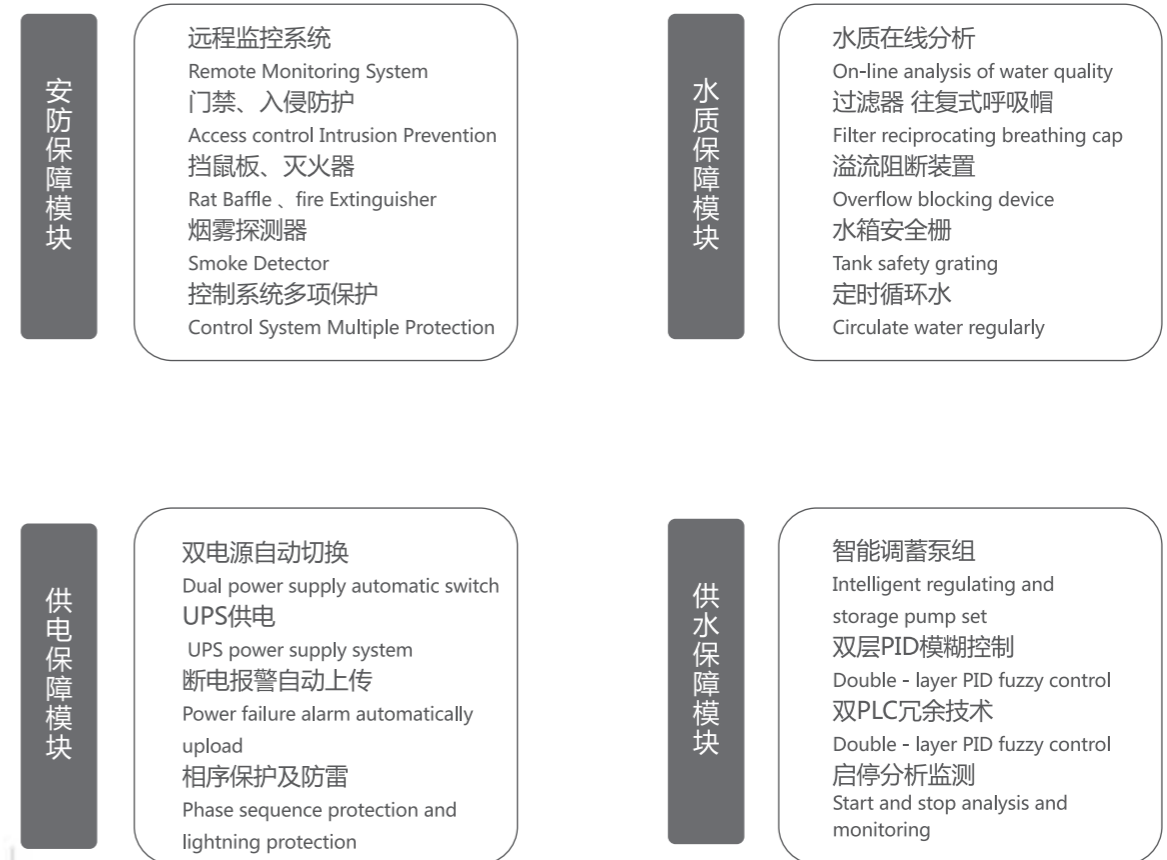
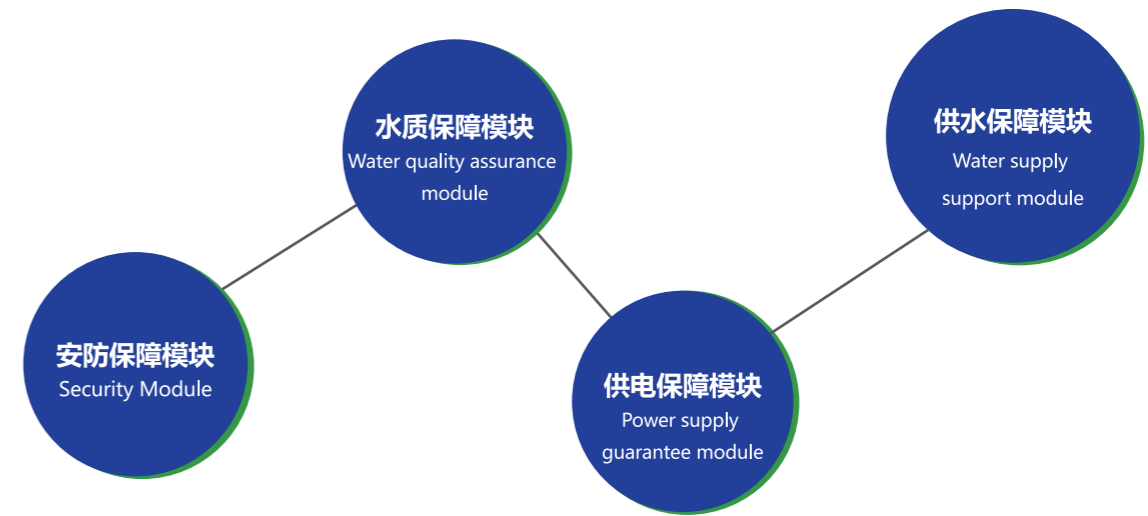

技术研发

TECHNOLOGY RESEARCH AND DEVELOPMENT

专业的产品设计研发团队，全面涵盖水处理工艺技术、机械设计、流体分析，自动化控制、电子技术、产品设计等。

A professional product design and development team, covering water treatment process technology, mechanical design, fluid analysis, automatic control, electronic technology, product design, etc.

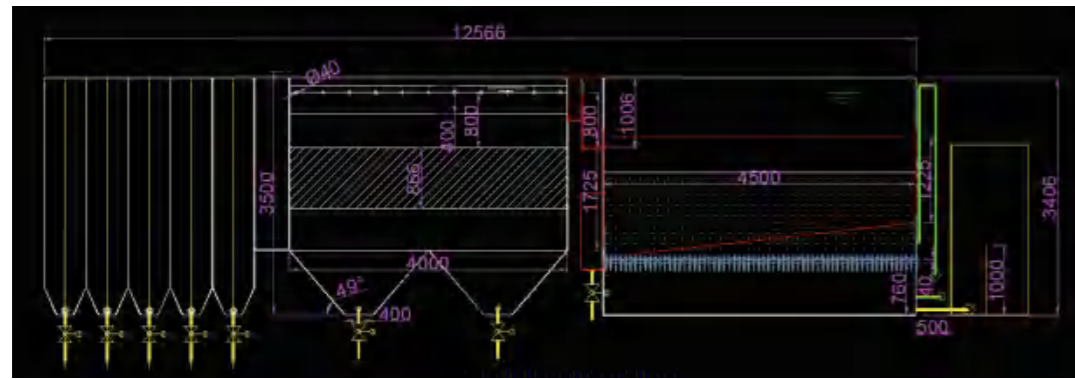

与同济大学建立“艺迈-同济联合实验室”致力于水处理工艺技术开发，提供更加安全、健康的净水处理技术及解决方案。

Establish "Yimai Tongji Joint Laboratory" with Tongji University to focus on the development of water treatment process technology and provide safer and healthier water purification technology and solutions.



获批“金山区企业技术中心”，体现团队研发创新能力。

It was approved as "Jinshan enterprise technology center", reflecting the team's R & D and innovation ability.

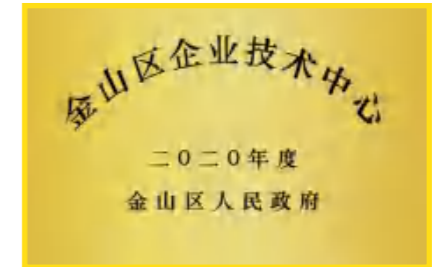

建立集成水厂分析调试测试中心，每台设备调试测试完全合格，投入市场。

An integrated water plant analysis, commissioning and testing center shall be established, and each equipment shall be fully qualified for commissioning and testing and put into the market.

拥有精良机械制造设备，为产品研发工程样机制造提供可靠保障。

It has sophisticated machinery manufacturing equipment to provide reliable guarantee for product R & D and engineering prototype manufacturing.

以生活饮用水实施标准《GB 5749-2022》，全面保障供水安全和品质。

The safety and quality of water supply shall be fully guaranteed according to the implementation standard of domestic drinking water GB 5749-2022.



生产工艺

PRODUCTION PROCESS

我司在多年的生产实践中一直保持着对设备工艺的高度投入与关注，真正诠释着在互联网信息时代下工业企业秉承的“工匠精神”。用最好的工艺技术为客户生产出高性能的产品，用严谨甚至于苛刻的标准做好我们的产品和服务。

Our company has maintained a high degree of input and attention to equipment and technology in the production practice for many years, truly interpreting the industrial enterprises in the Age of Internet information Adhering to the "craftsman spirit". With the best technology for customers to produce high-performance products, with rigorous and even demanding standards to do our production Products and services.



原材料检测
Raw material testing

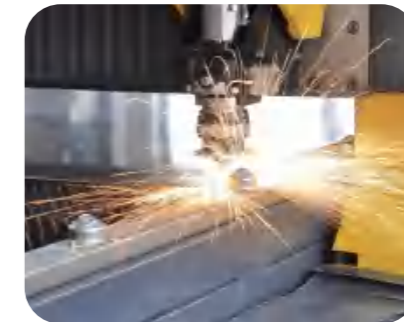

精密激光切割技术
Precision laser cutting technology

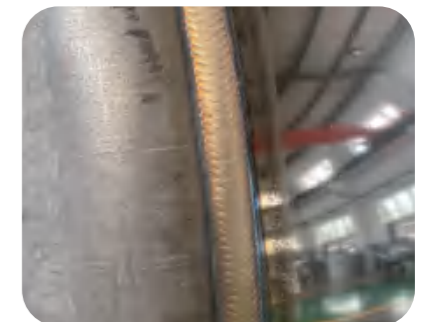

全自动精密焊接技术
Fully automatic precision welding technology



因地制宜 因况制宜
Creative introduction of cold drawing process



标准化零部件
Standardized parts



全方位性能测试平台
Creative introduction of cold drawing process

我司工厂、分公司和办事处均设置备品备件仓库，确保售后服务及时可靠。零部件全部实行标准化生产，实现通用和互换，为用户提供最便捷的服务体验。

Our factory and office are set up spare parts warehouse, to ensure timely and reliable after-sales service, all the parts are standardized production, to achieve common and interchangeable, to provide users with the most convenient service experience.

部分项目案例 SOME PROJECT CASES



- 孝义梧桐镇后营村一体化水厂项目，处理量1200m³/d
Integrated water plant project in Houying village, Wutong Town, Xiaoyi City, processing capacity 1200m³/ day
- 北京某部队某营地供水一体化水厂项目，处理量2400m³/d
Integrated water plant project in a military camp in Beijing, processing capacity 2400m³ / day
- 俞邦村一体化水厂项目，处理量5000m³/d
Integrated water plant project in Yubang village, processing capacity 5000m³/ day
- 平山村一体化水厂项目，处理量3000m³/d
Integrated water plant project in Pingshan village, processing capacity 3000m³ / day
- 宁海县西岙村一体化水厂项目，处理量2000m³/d
Integrated water plant project in Xi'ao village, Ninghai County, processing capacity 2000m³ / day
- 坡心村一体化水厂项目，处理量1200m³/d
Integrated water plant project in Poxin village, processing capacity 1200m³ / day
- 中屏镇中屏村一体化水厂项目，处理量2400m³/d
Integrated water plant project in Zhongping village, Zhongping Town, processing capacity 2400m³/ day

.....



艺迈服务
YIMAI SERVICE



艺迈，着力为客户提供一种全生命周期的服务，在与您初识的那一刻，我们的服务已经悄然而至，在与您沟通的每一瞬间，我们的服务无处不在。

多元售后—辐射全国

MULTIVARIATE-SALES-RADIATION ACROSS THE COUNTRY

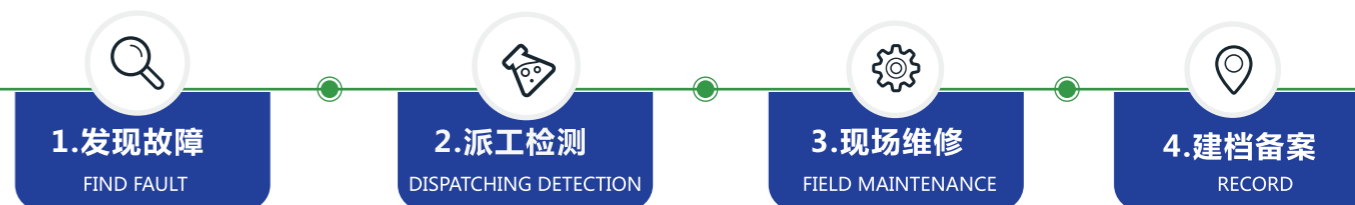

YIMAI FOCUSES ON PROVIDING CUSTOMERS WITH A FULL LIFE CYCLE SERVICE. THE MOMENT WE FIRST MEET YOU, OUR SERVICE HAS QUIETLY ARRIVED, AND EVERY MOMENT OF COMMUNICATION WITH YOU, OUR SERVICE IS EVERYWHERE.



产品全生命周期管理
PRODUCT LIFECYCLE MANAGEMENT

